

**NOTICE!!**

**These documents have been scanned!**

**Do not place un-scanned documents beneath this notice!**

**Do not remove this notice from this file!**

GPO Jacket No. 560-102  
Print Order 61540  
Rise Business Services, LLC  
Job=AZ15 7/9/2019



Box Number= AZ15152



Claim Begin-End: AMC449078-AMC449093

**1 Initial Receipt**



AZ15152-15

AMC448714-AMC449477

**United States Department of the Interior**  
**Bureau of Land Management**  
 DIV OF LANDS, MINRLS & ENERGY  
 ONE N CENTRAL AVE  
 PHOENIX, AZ 85004 -4427  
 Phone: 602-417-9200

Receipt

No: 4083842

<b>Transaction #:</b> 4195834	
<b>Date of Transaction:</b> 02/08/2018	
CUSTOMER:	
	ACUITY RESOURCES LLC 2140 S DUPONT HWY CAMDEN,DE 19934-1249 US

**ENTERED**  
 FEB 14 2018  
 BY: *RAm*

LINE #	QTY	DESCRIPTION	REMARKS	UNIT PRICE	TOTAL
1	16.00	LOCATABLE MINERALS / MINING CLAIMS-NEW,UNADJUD, ONE OR MORE AUTH NOS / NEW MINING CLAIM PROCESSING FEE <b>CASES:</b> AMC449078/\$20.00, AMC449079/\$20.00, AMC449080/\$20.00, AMC449081/\$20.00, AMC449082/\$20.00, AMC449083/\$20.00, AMC449084/\$20.00, AMC449085/\$20.00, AMC449086/\$20.00, AMC449087/\$20.00, AMC449088/\$20.00, AMC449089/\$20.00, AMC449090/\$20.00, AMC449091/\$20.00, AMC449092/\$20.00, AMC449093/\$20.00		- n/a -	320.00
2	16.00	LOCATABLE MINERALS / MINING CLAIMS-NEW,UNADJUD, ONE OR MORE AUTH NOS / NEW MINING CLAIMS LOCATION FEE <b>CASES:</b> AMC449078/\$37.00, AMC449079/\$37.00, AMC449080/\$37.00, AMC449081/\$37.00, AMC449082/\$37.00, AMC449083/\$37.00, AMC449084/\$37.00, AMC449085/\$37.00, AMC449086/\$37.00, AMC449087/\$37.00, AMC449088/\$37.00, AMC449089/\$37.00, AMC449090/\$37.00, AMC449091/\$37.00, AMC449092/\$37.00, AMC449093/\$37.00		- n/a -	592.00
3	16.00	LOCATABLE MINERALS / MINING CLAIMS-NEW,UNADJUD, ONE OR MORE AUTH NOS / NEW MINING CLAIMS MAINTENANCE FEE <b>CASES:</b> AMC449078/\$155.00, AMC449079/\$155.00, AMC449080/\$155.00, AMC449081/\$155.00, AMC449082/\$155.00, AMC449083/\$155.00, AMC449084/\$155.00, AMC449085/\$155.00, AMC449086/\$155.00, AMC449087/\$155.00,		- n/a -	2480.00

	AMC449088/\$155.00, AMC449089/\$155.00, AMC449090/\$155.00, AMC449091/\$155.00, AMC449092/\$155.00, AMC449093/\$155.00			
<b>TOTAL:</b>				<b>\$3,392.00</b>

PAYMENT INFORMATION			
1	AMOUNT:	3392.00	POSTMARKED: N/A
	TYPE:	CHECK	RECEIVED: 02/07/2018
	CHECK NO:	1009	
	NAME:	R & D ADVENTURES LLC ORO VALLEY AZ 85755 US	

REMARKS

This receipt was generated by the automated BLM Collections and Billing System and is a paper representation of a portion of the official electronic record contained therein.

**NOTICE!!**

**These documents have been scanned!**

**Do not place un-scanned documents beneath this notice!**

**Do not remove this notice from this file!**

GPO Jacket No. 560-102  
Print Order 61540  
Rise Business Services, LLC  
Job=AZ15 7/9/2019



Box Number= AZ15152



Claim Begin-End: AMC449078-AMC449093

**2 Correspondence**



AZ15152-15

AMC448714-AMC449477

**NO  
DOCUMENTS  
FOUND**

NO DOCUMENTS FOUND  
NO DOCUMENTS FOUND

**NOTICE!!**

**These documents have been scanned!**

**Do not place un-scanned documents beneath this notice!**

**Do not remove this notice from this file!**

GPO Jacket No. 560-102  
Print Order 61540  
Rise Business Services, LLC  
Job=AZ15 7/9/2019



Box Number= AZ15152



Claim Begin-End: AMC449078-AMC449093

**3 Transfers**



AZ15152-15

AMC448714-AMC449477

**NO  
DOCUMENTS  
FOUND**

NO DOCUMENTS FOUND  
NO DOCUMENTS FOUND

**NOTICE!!**

**These documents have been scanned!**

**Do not place un-scanned documents beneath this notice!**

**Do not remove this notice from this file!**

GPO Jacket No. 560-102  
Print Order 61540  
Rise Business Services, LLC  
Job=AZ15 7/9/2019



Box Number= AZ15152



Claim Begin-End: AMC449078-AMC449093

**4 Annual Filings**



AZ15152-15

AMC448714-AMC449477



DEPARTMENT OF THE INTERIOR  
BUREAU OF LAND MANAGEMENT  
MINING CLAIMS

Run Date/Time: 9/11/2018

MC Maintenance Fees Paid Through the BLM Pay Portal  
(by Date Paid)

Page 644 Of 723

**CBS Receipt: 4252508**

Printed For Lead File # AMC449078

Agency Tracking ID: 1535737376

Assessment Year: 2019

Number of BLM Serial Nr: 16

Paid On: 8/31/2018

Total Amount Paid: \$2,480.00

Claim Name	BLM Serial No	Lead File No	Amount Paid
ACUITY 01	AMC449078	AMC449078	\$155.00
ACUITY 02	AMC449079	AMC449078	\$155.00
ACUITY 03	AMC449080	AMC449078	\$155.00
ACUITY 04	AMC449081	AMC449078	\$155.00
ACUITY 05	AMC449082	AMC449078	\$155.00
ACUITY 06	AMC449083	AMC449078	\$155.00
ACUITY 07	AMC449084	AMC449078	\$155.00
ACUITY 08	AMC449085	AMC449078	\$155.00
ACUITY 09	AMC449086	AMC449078	\$155.00
ACUITY 10	AMC449087	AMC449078	\$155.00
ACUITY 11	AMC449088	AMC449078	\$155.00
ACUITY 12	AMC449089	AMC449078	\$155.00
ACUITY 13	AMC449090	AMC449078	\$155.00
ACUITY 14	AMC449091	AMC449078	\$155.00
ACUITY 15	AMC449092	AMC449078	\$155.00
ACUITY 16	AMC449093	AMC449078	\$155.00

**United States Department of the Interior**  
**Bureau of Land Management**  
 BUSINESS & SUPPORT SVCS DIV  
 ONE N CENTRAL AVE SUITE 800  
 PHOENIX, AZ 85004 -4427  
 Phone: 602-417-9200

Receipt

No: 4252508

<b>Transaction #:</b> 4368026	
<b>Date of Transaction:</b> 08/31/2018	
CUSTOMER:	
JAG DHILLON 752 QUEEN STREET WEST TORONTO, ON M6J 1E9 CA	

LINE #	QTY	DESCRIPTION	REMARKS	UNIT PRICE	TOTAL
1	1.00	LOCATABLE MINERALS / MINING CLAIMS-NOT NEW-UNADJUD, ONE AUTH NO. ONLY / MINING CLAIM MONEY RECEIVED <b>CASES: AMC449078/\$2480.00</b>		- n/a -	2480.00
<b>TOTAL:</b>					<b>\$2,480.00</b>

PAYMENT INFORMATION			
NOTE: Items will appear on credit card statement as "BLM O Mining Claim".			
1	AMOUNT:	2480.00	POSTMARKED: N/A
	TYPE:	CREDIT CARD	RECEIVED: 08/31/2018
	NAME:	JAG DHILLON 752 QUEEN STREET WEST TORONTO ON M6J 1E9 CA	
	CARD NO:	XXXXXXXXXXXX3386	AUTH CODE: 037269
	NAME ON CARD:	JAG DHILLON	
	SIGNATURE:		

REMARKS

This receipt was generated by the automated BLM Collections and Billing System and is a paper representation of a portion of the official electronic record contained therein.

**NOTICE!!**

**These documents have been scanned!**

**Do not place un-scanned documents beneath this notice!**

**Do not remove this notice from this file!**

GPO Jacket No. 560-102  
Print Order 61540  
Rise Business Services, LLC  
Job=AZ15 7/9/2019



Box Number= AZ15152



Claim Begin-End: AMC449078-AMC449093

**5 Miscellaneous**



AZ15152-15

AMC448714-AMC449477

**NO  
DOCUMENTS  
FOUND**

NO DOCUMENTS FOUND  
NO DOCUMENTS FOUND

**NOTICE!!**

**These documents have been scanned!**

**Do not place un-scanned documents beneath this notice!**

**Do not remove this notice from this file!**

GPO Jacket No. 560-102  
Print Order 61540  
Rise Business Services, LLC  
Job=AZ15 7/9/2019



Box Number= AZ15152



Claim Begin-End: AMC449078-AMC449093

**6 Location Notices-Amendments and Supporting Documents**



AZ15152-15

AMC448714-AMC449477

**MINING CLAIM STATUS REPORT**

Data Entered: 2/14/18 RAM

MTP Checked By: 2/14/18 RAM

GEO Checked By: 2/14/18 RAM

LEAD SERIAL NUMBER: AMC 449078 thru AMC 449093

**NUMBER OF CLAIMS & TYPE:**

16 LODGE  
PLACER  
ASSOCIATION PLACER  
MILL SITE  
TUNNEL SITE

**CHARGES:**

Processing Fee @ \$20 = \$ 320  
Location Fee @ \$37 = \$ 592  
Maintenance Fee @ \$155 = \$ 2,480  
Add'l Maint Fee for Assoc Placer = \$ \_\_\_\_\_  
**SUBTOTAL** \$ \_\_\_\_\_  
Other Fees \$ \_\_\_\_\_  
Other Fees \$ \_\_\_\_\_  
**TOTAL** \$ 3,392

TOTAL ACREAGE: \_\_\_\_\_ Per Claim  
(Placer Only)

NUMBER OF LOCATORS: \_\_\_\_\_

DOCUMENTS RECEIVED VIA: Over-the-Counter [ ] Mail [  ] TIMELY FILED: Yes [  ] No [ ]

LEGAL DESCRIPTION: T 9S R 11E SEC 28  
T \_\_\_\_\_ R \_\_\_\_\_ SEC \_\_\_\_\_  
T \_\_\_\_\_ R \_\_\_\_\_ SEC \_\_\_\_\_  
T \_\_\_\_\_ R \_\_\_\_\_ SEC \_\_\_\_\_  
T \_\_\_\_\_ R \_\_\_\_\_ SEC \_\_\_\_\_

BLM [ ] FOREST SERVICE [ ] \_\_\_\_\_ SUBJ TO PL 359: Yes [ ] No [ ]  
WILDERNESS AREA [ ] \_\_\_\_\_

SPLIT ESTATE: N/A [ ] SX [ ] PX [ ] OTHER [ ] \_\_\_\_\_  
SRHA [ ] Was proper Notice filed if located on SHRA Land? Yes [ ] No [ ]

**RECONVEYED MINERALS ON BLM LAND REQUIRE OPENING ORDER FROM 1944 TO 1993:**

Open to Entry On \_\_\_\_\_ N/A [ ]

COMMENTS/STATUS: VOID [ ] PARTIALLY VOID [ ] PVT MINERALS [ ] WITHDRAWN LANDS [ ]  
OTHER [ ] \_\_\_\_\_

[ ] Claimant acknowledges that portions of the following claim(s) site(s) may be void or voidable.

Printed Name of Claimant \_\_\_\_\_ Signature of Claimant \_\_\_\_\_

\*\*\*\*\*FINAL ADJUDICATION\*\*\*\*\*

DATE \_\_\_\_\_ INITIALS \_\_\_\_\_

AMC 449078

COPY

**LOCATION NOTICE FOR PLACER MINING CLAIM**

NOTICE IS HEREBY GIVEN that the Acuity 01 placer mining claim has been located by ACUITY RESOURCES LLC. whose current mailing address is 2140 S. DuPont Hwy. Camden, Delaware 19934

BLM			
DATE	PHOENIX, ARIZONA	2018 FEB -7 P 2:08	RECEIVED
STAMP			BLM ARIZONA STATE OFFICE

The general course of the claim is East to West and is situated in Pinal County, Arizona.

The claim is 1,320 feet in length and 660 feet in width. This claim runs from the location monument on which the location notice is posted (being the northeast corner of the said claim), approximately 660 feet in a southerly direction to the south end line and 1,320 feet in a westerly direction to the west end line.

The claim is marked by four 2"x2"x4' monuments, one at each corner of the claim.

The location monument on which this notice is posted is situated within Section 28, Township 9 South, Range 11 East, Gila Salt River Base and Meridian, Arizona. This claim encompasses portions of the following: N 1/2, NE 1/4, SE 1/4, Section 28, Township 9 South, Range 11 East.

Gila Salt River Base and Meridian, Arizona.

The locality of this claim with reference to some natural object or permanent monument and additional information (if any) concerning its locality are as follows: None

DATED AND POSTED on the ground this 3rd day of January, 2018.

LOCATOR (s) Owners

ACUITY RESOURCES LLC.

By 

Ron Parker/Agent for Owners

AMC449078

AMC 449078

# T9S, R11E Section 28,

# Acuity Claims

RECEIVED  
BLM AZ STATE OFFICE  
2010 FEB -7 P 2:02  
PHOENIX, ARIZONA

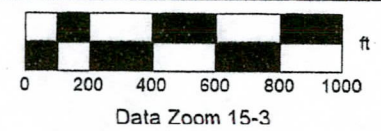
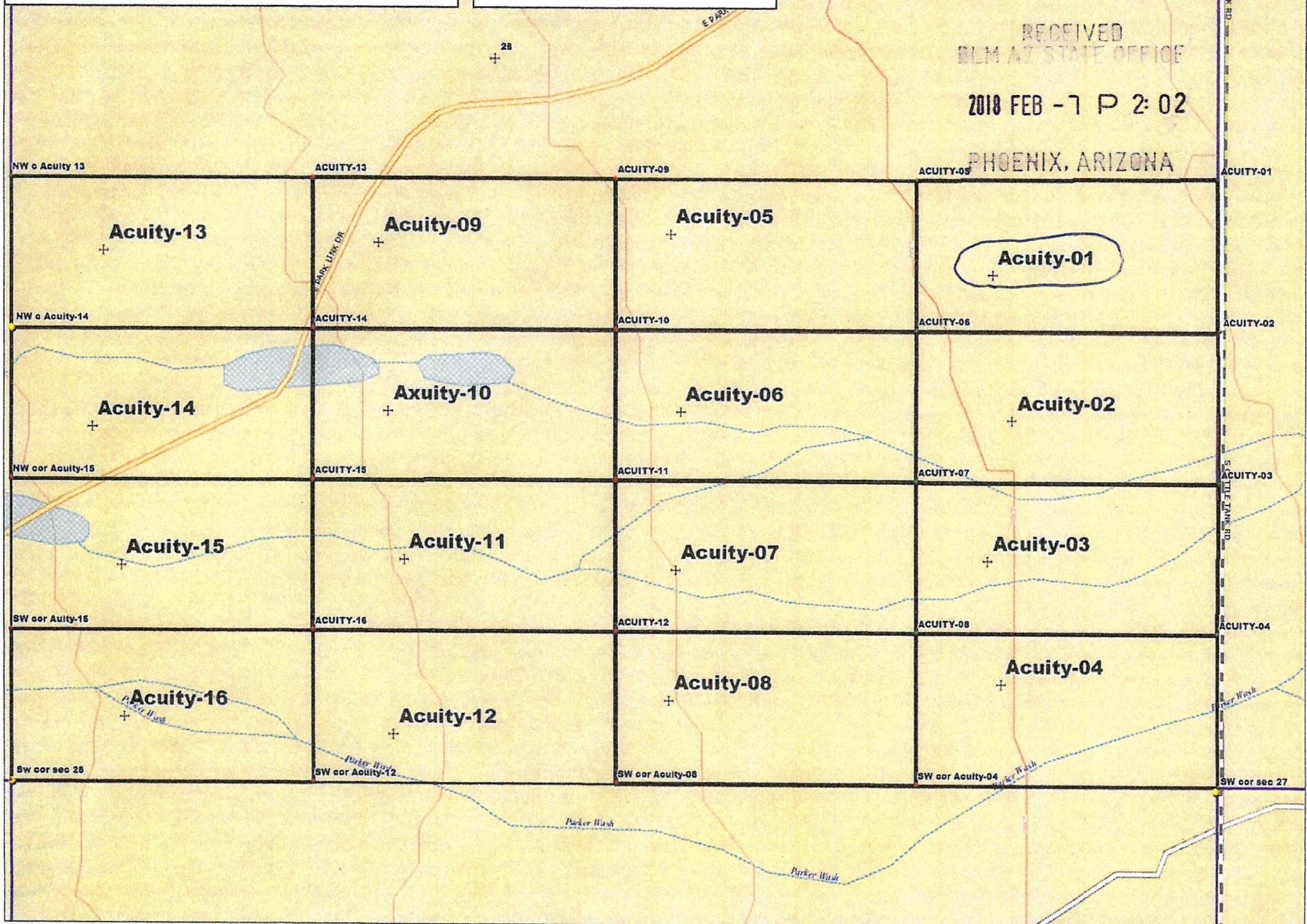



**LOCATION NOTICE FOR PLACER MINING CLAIM**

NOTICE IS HEREBY GIVEN that the Acuity 02 placer mining claim has been located by ACUITY RESOURCES LLC. whose current mailing address is 2140 S. DuPont Hwy. Camden, Delaware 19934

RECEIVED  
BLM AZ STATE OFFICE  
2018 FEB - 1 P 2:02  
PHOENIX, ARIZONA

The general course of this claim is East to West and is situated in Pinal County, Arizona.

The claim is 1,320 feet in length and 660 feet in width. This claim runs from the location monument on which the location notice is posted (being the northeast corner of the said claim), approximately 660 feet in a southerly direction to the south end line and 1,320 feet in a westerly direction to the west end line.

The claim is marked by four 2"x2"x4' monuments, one at each corner of the claim.

The location monument on which this notice is posted is situated within Section 28, Township 9 South, Range 11 East, Gila Salt River Base and Meridian, Arizona. This claim encompasses portions of the following: S 1/2, NE 1/4, SE 1/4, Section 28, Township 9 South, Range 11 East.

Gila Salt River Base and Meridian, Arizona.

The locality of this claim with reference to some natural object or permanent monument and additional information (if any) concerning its locality are as follows: None

DATED AND POSTED on the ground this 3rd day of January, 2018.

LOCATOR (s) Owners

ACUITY RESOURCES LLC.

By 

Ron Parker/Agent for Owners

AMC449079

# T9S, R11E Section 28,

# Acuity Claims

AMC449079

RECEIVED  
BLM AZ STATE OFFICE  
2010 FEB -7 P 2:02  
PHOENIX, ARIZONA

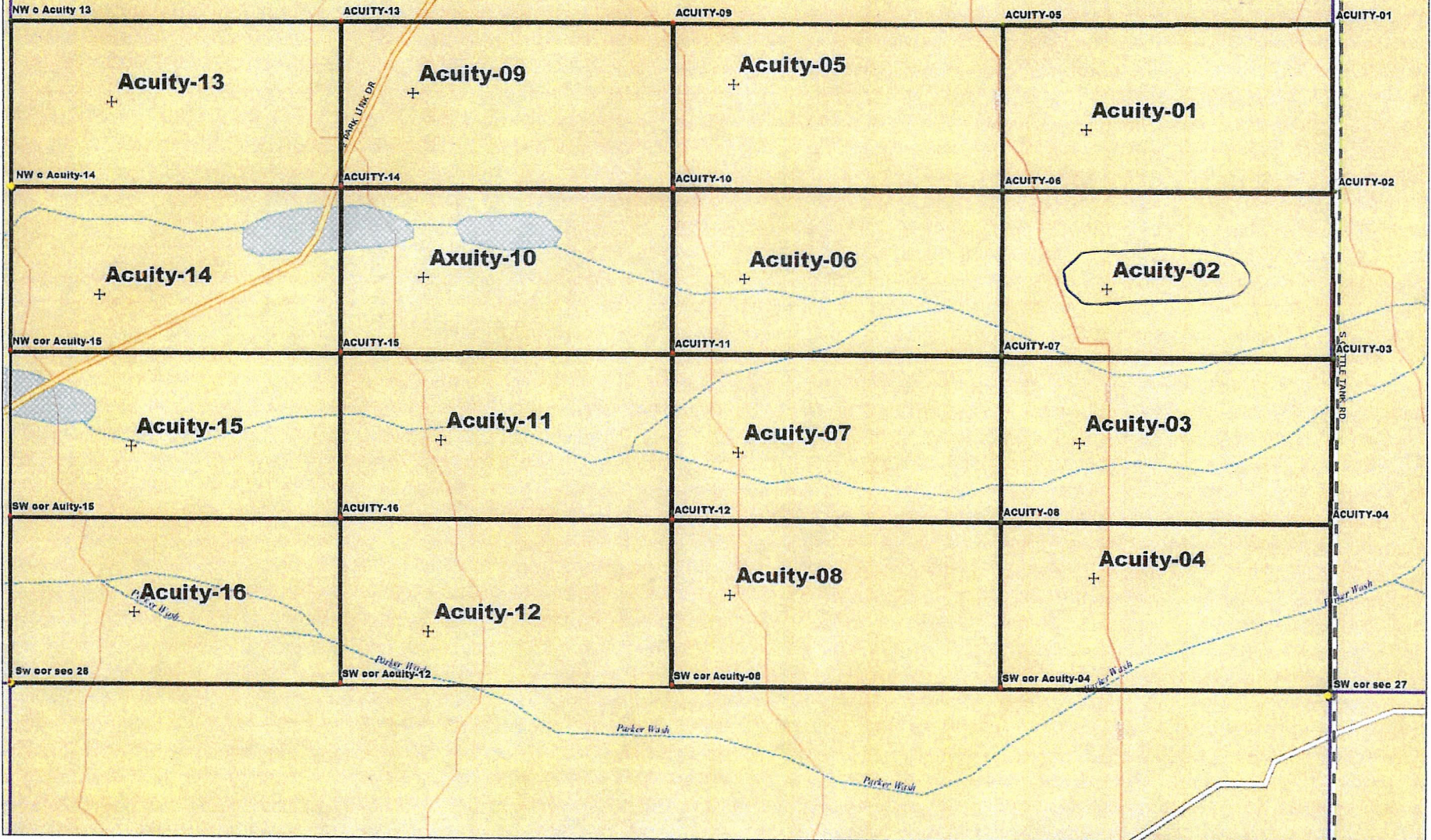

Data use subject to license.

© DeLorme. Topo North America™ 10.

www.delorme.com

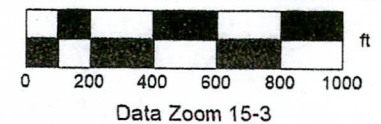

**LOCATION NOTICE FOR PLACER MINING CLAIM**

NOTICE IS HEREBY GIVEN that the Acuity 03 placer mining claim has been located by ACUITY RESOURCES LLC. whose current mailing address is 2140 S. DuPont Hwy. Camden, Delaware 19934.

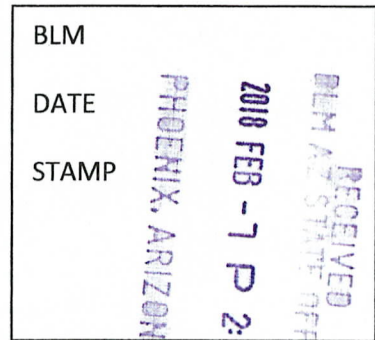

The general course of this claim is East to West and is situated in Pinal County, Arizona.

The claim is 1,320 feet in length and 660 feet in width. This claim runs from the location monument on which the location notice is posted (being the northeast corner of the said claim), approximately 660 feet in a southerly direction to the south end line and 1,320 feet in a westerly direction to the west end line.

The claim is marked by four 2"x2"x4' monuments, one at each corner of the claim.

The location monument on which this notice is posted is situated within Section 28, Township 9 South, Range 11 East, Gila Salt River Base and Meridian, Arizona. This claim encompasses portions of the following: N 1/2, SE 1/4, SE 1/4, Section 28, Township 9 South, Range 11 East.

Gila Salt River Base and Meridian, Arizona.

The locality of this claim with reference to some natural object or permanent monument and additional information (if any) concerning its locality are as follows: None

DATED AND POSTED on the ground this 3rd day of January, 2018.

LOCATOR (s) Owners

ACUITY RESOURCES LLC.

By

Ron Parker/Agent for Owners

AHC449080

# T9S, R11E Section 28,

# Acuity Claims

AMC449080

RECEIVED  
BLM AZ STATE OFFICE  
2018 FEB -7 P 2:02  
PHOENIX, ARIZONA

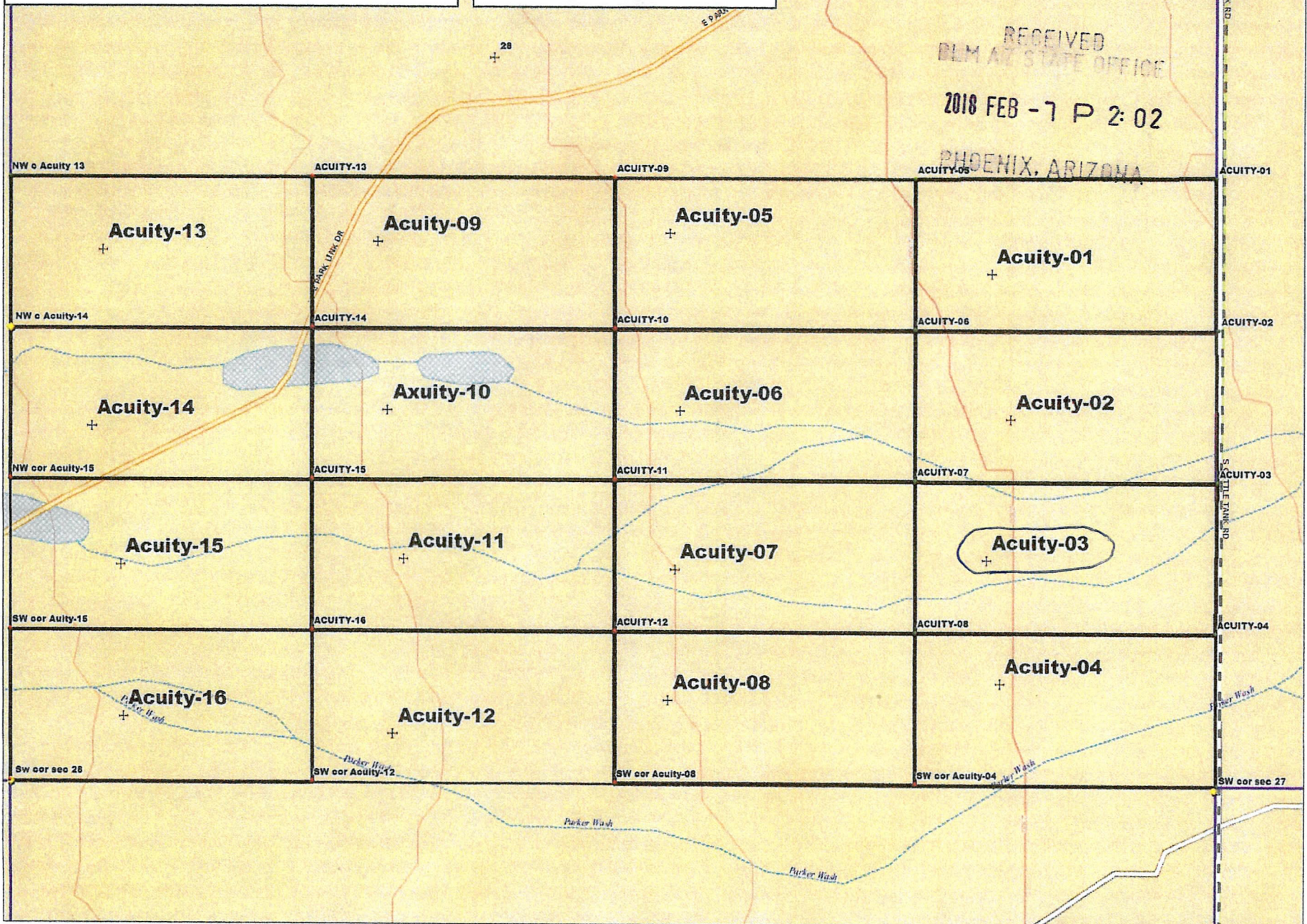

Data use subject to license.

© DeLorme. Topo North America™ 10.

www.delorme.com

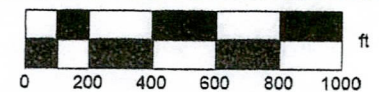

Data Zoom 15-3

**LOCATION NOTICE FOR PLACER MINING CLAIM**

NOTICE IS HEREBY GIVEN that the Acuity 04 placer mining claim has been located by ACUIY RESOURCES LLC. whose current mailing address is 2140 S. DuPont Hwy. Camden, Delaware 19934.

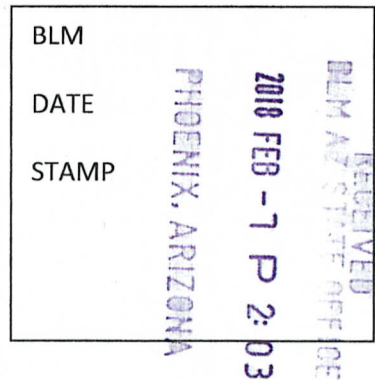

The general course of this claim is East to West and is situated in Pinal County, Arizona.

The claim is 1,320 feet in length and 660 feet in width. This claim runs from the location monument on which the location notice is posted (being the northeast corner of the said claim), approximately 660 feet in a southerly direction to the south end line and 1,320 feet in a westerly direction to the west end line.

The claim is marked by four 2"x2"x4' monuments, one at each corner of the claim.

The location monument on which this notice is posted is situated within Section 28, Township 9 South, Range 11 East, Gila Salt River Base and Meridian, Arizona. This claim encompasses portions of the following: S 1/2, SE 1/4, SE 1/4, Section 28, Township 9 South, Range 11 East.

Gila Salt River Base and Meridian, Arizona.

The locality of this claim with reference to some natural object or permanent monument and additional information (if any) concerning its locality are as follows: None

DATED AND POSTED on the ground this 3rd day of January, 2018.

LOCATOR (s) Owners

ACUIY RESOURCES LLC.

By 

Ron Parker/Agent for Owners

AMC449081

AMC449081

# T9S, R11E Section 28,

# Acuity Claims

RECEIVED  
 DLM AZ STATE OFFICE  
 2018 FEB -7 P 2:03  
 PHOENIX, ARIZONA

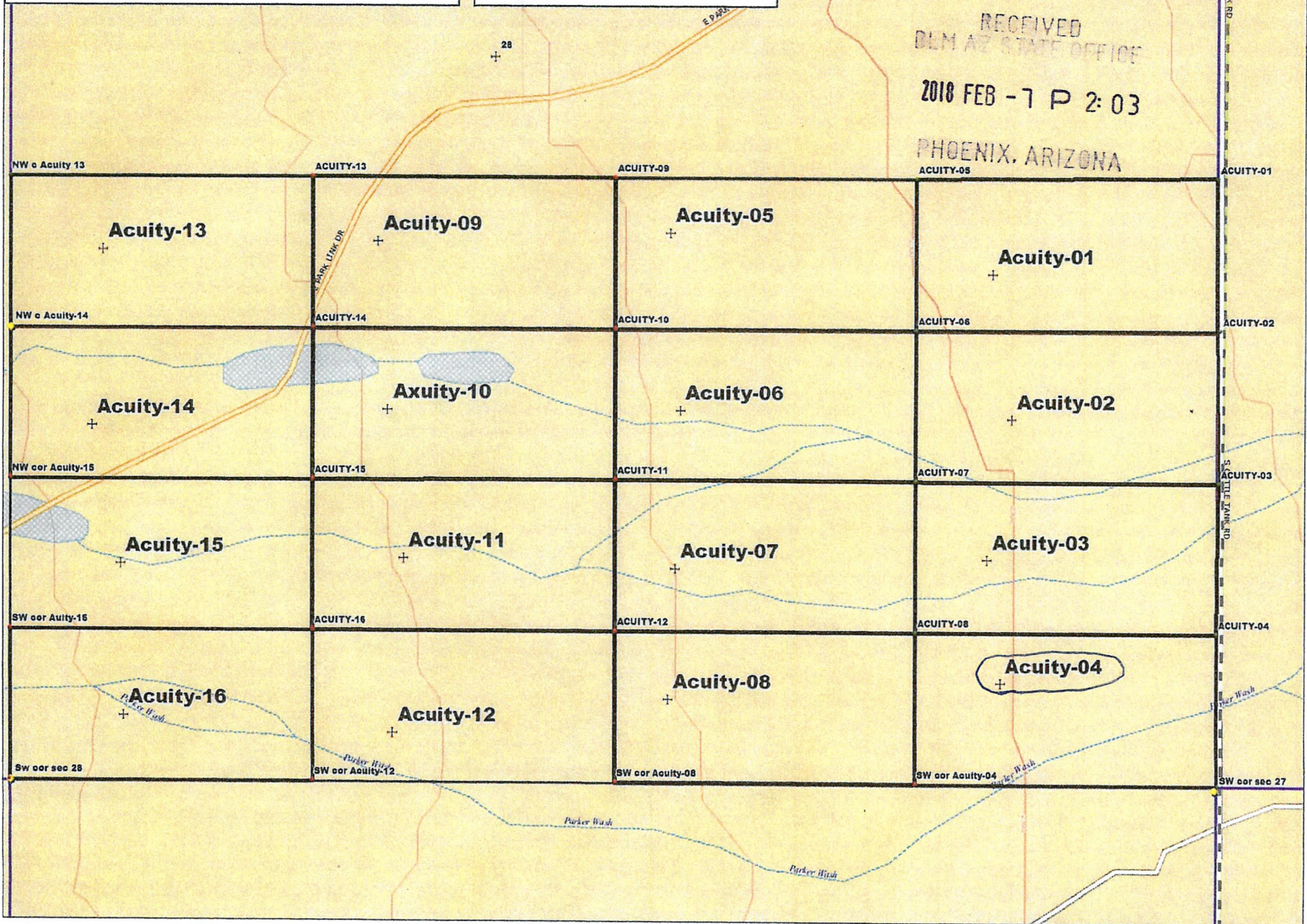

Data use subject to license.

© DeLorme. Topo North America™ 10.

www.delorme.com

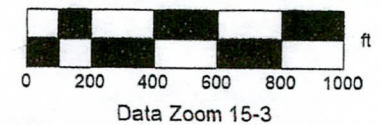

**LOCATION NOTICE FOR PLACER MINING CLAIM**

NOTICE IS HEREBY GIVEN that the Acuity 05 placer mining claim has been located by ACUITY RESOURCES LLC. whose current mailing address is 2140 S. DuPont Hwy. Camden, Delaware 19934.

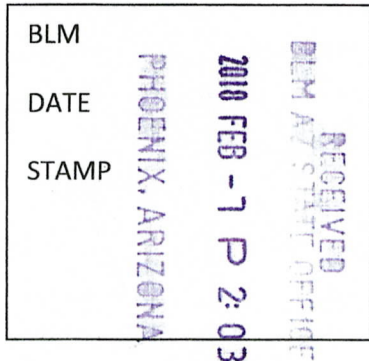

The general course of this claim is East to West and is situated in Pinal County, Arizona.

The claim is 1,320 feet in length and 660 feet in width. This claim runs from the location monument on which the location notice is posted (being the northeast corner of the said claim), approximately 660 feet in a southerly direction to the south end line and 1,320 feet in a westerly direction to the west end line.

The claim is marked by four 2"x2"x4' monuments, one at each corner of the claim.

The location monument on which this notice is posted is situated within Section 28, Township 9 South, Range 11 East, Gila Salt River Base and Meridian, Arizona. This claim encompasses portions of the following: N 1/2, NW 1/4, SE 1/4, Section 28, Township 9 South, Range 11 East.

Gila Salt River Base and Meridian, Arizona.

The locality of this claim with reference to some natural object or permanent monument and additional information (if any) concerning its locality are as follows: None

DATED AND POSTED on the ground this 3rd day of January, 2018.

LOCATOR (s) Owners

ACUITY RESOURCES LLC.

By

Ron Parker/Agent for Owners

AMC449082

# T9S, R11E Section 28,

# Acuity Claims

AMC449082

RECEIVED  
BLM AZ STATE OFFICE  
2018 FEB -7 P 2:03  
PHOENIX, ARIZONA

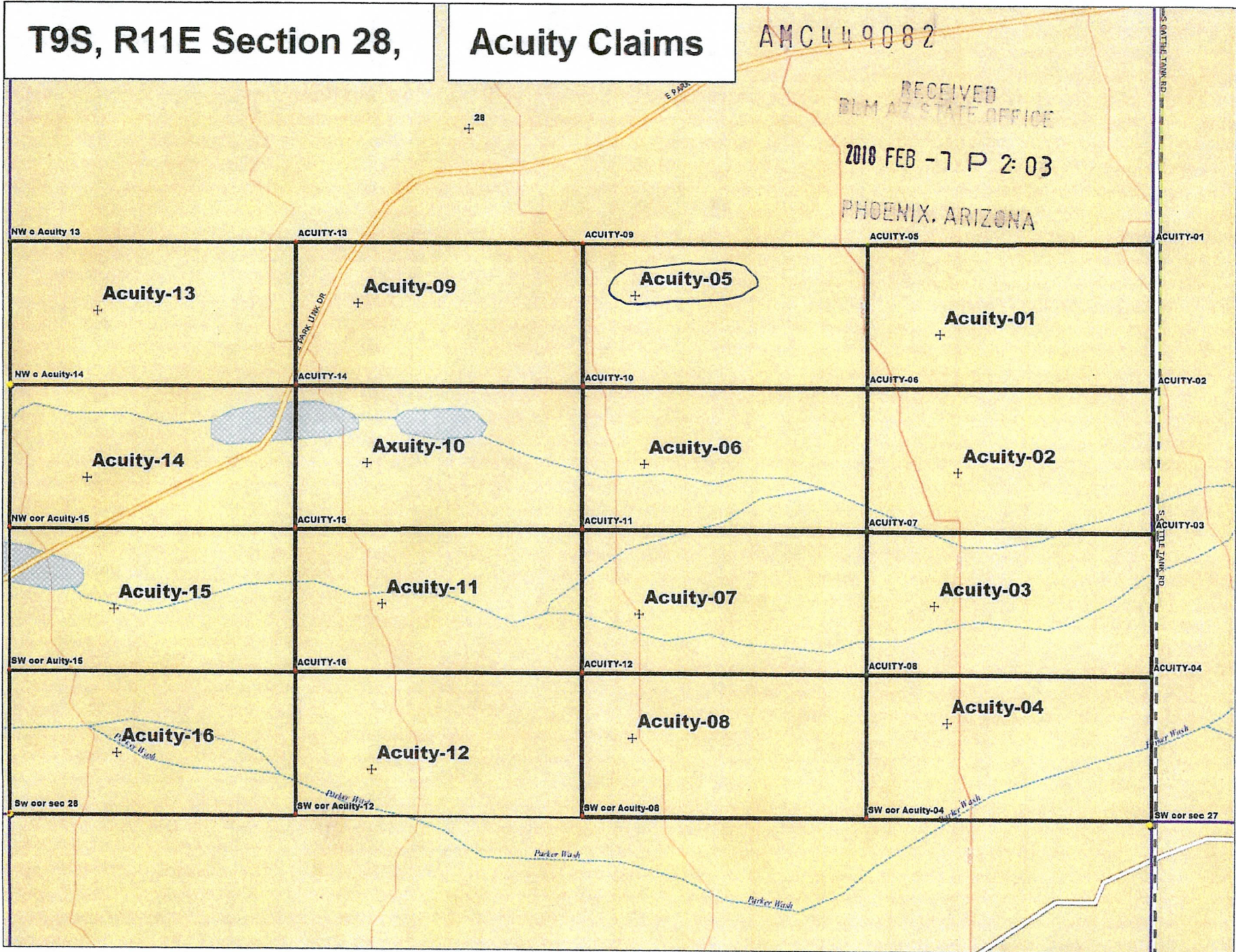

Data use subject to license.

© DeLorme. Topo North America™ 10.

www.delorme.com

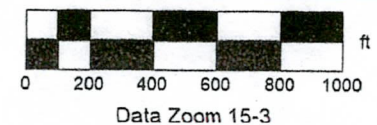



**LOCATION NOTICE FOR PLACER MINING CLAIM**

NOTICE IS HEREBY GIVEN that the Acuity 06 placer mining claim has been located by ACUITY RESOURCES LLC. whose current mailing address is 2140 S. DuPont Hwy. Camden, Delaware 19934

RECEIVED  
BLM AZ STATE OFFICE  
2018 FEB -7 P 2:04  
PHOENIX, ARIZONA

The general course of this claim is East to West and is situated in Pinal County, Arizona.

The claim is 1,320 feet in length and 660 feet in width. This claim runs from the location monument on which the location notice is posted (being the northeast corner of the said claim), approximately 660 feet in a southerly direction to the south end line and 1,320 feet in a westerly direction to the west end line.

The claim is marked by four 2"x2"x4' monuments, one at each corner of the claim.

The location monument on which this notice is posted is situated within Section 28, Township 9 South, Range 11 East, Gila Salt River Base and Meridian, Arizona. This claim encompasses portions of the following: S 1/2, NW 1/4, SE 1/4, Section 28, Township 9 South, Range 11 East.

Gila Salt River Base and Meridian, Arizona.

The locality of this claim with reference to some natural object or permanent monument and additional information (if any) concerning its locality are as follows: None

DATED AND POSTED on the ground this 3rd day of January, 2018.

LOCATOR (s) Owners

ACUITY RESOURCES LLC.

By 

Ron Parker/Agent for Owners

AMC449083

# T9S, R11E Section 28,

# Acuity Claims

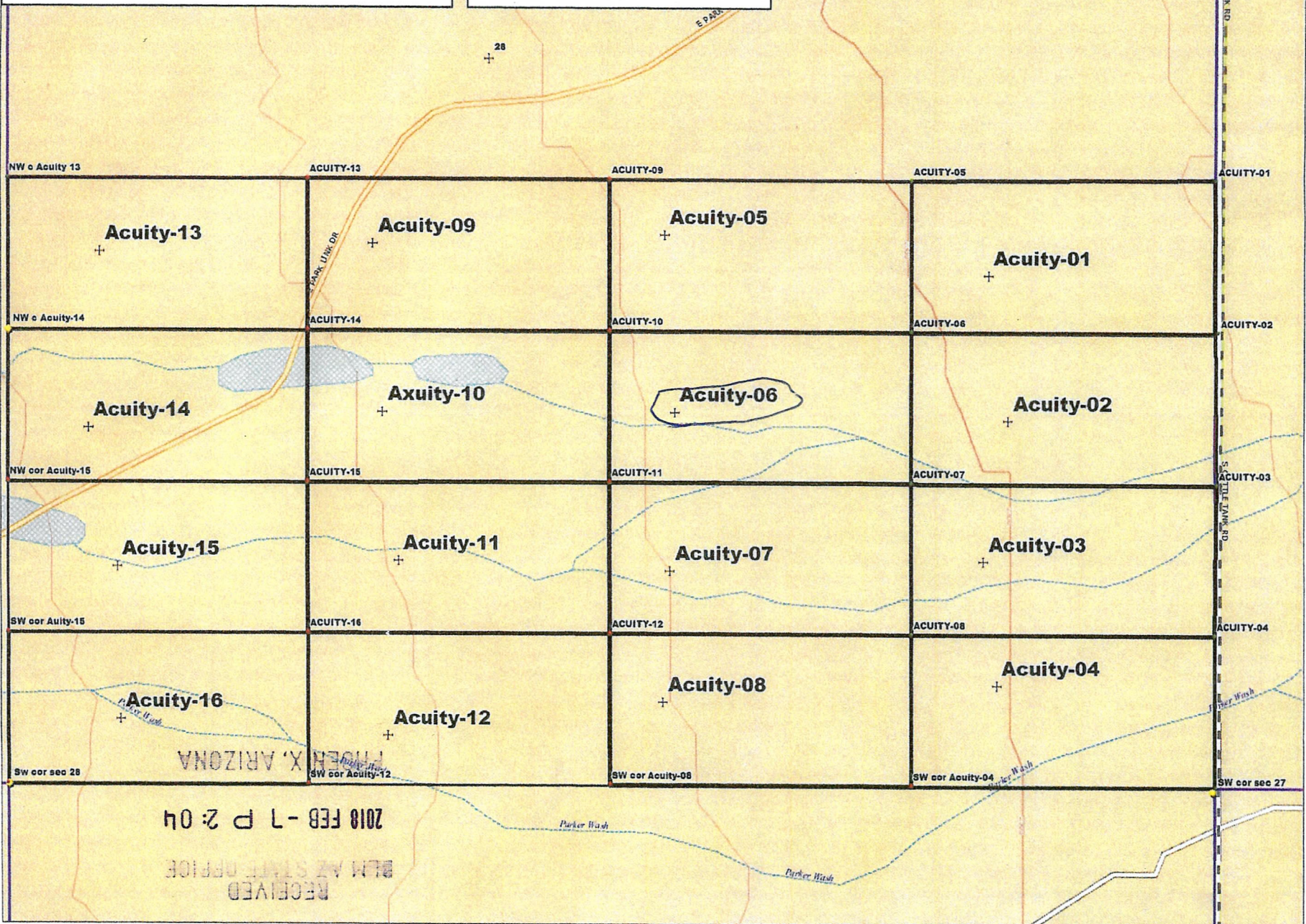

Data use subject to license.

© DeLorme. Topo North America™ 10.

www.delorme.com

AMC449083



MN (9.9° E)

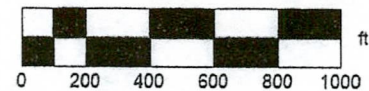

Data Zoom 15-3

**LOCATION NOTICE FOR PLACER MINING CLAIM**

NOTICE IS HEREBY GIVEN that the Acuity 07 placer mining claim has been located by ACUITY RESOURCES LLC. whose current mailing address is 2140 S. DuPont Hwy. Camden, Delaware 19934

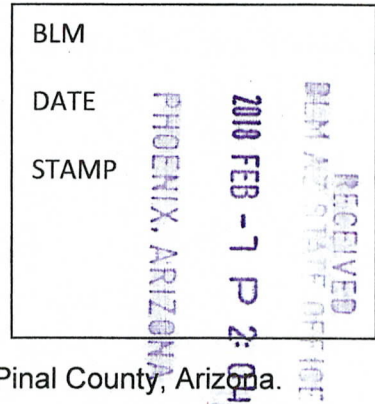

The general course of this claim is East to West and is situated in Pinal County, Arizona.

The claim is 1,320 feet in length and 660 feet in width. This claim runs from the location monument on which the location notice is posted (being the northeast corner of the said claim), approximately 660 feet in a southerly direction to the south end line and 1,320 feet in a westerly direction to the west end line.

The claim is marked by four 2"x2"x4' monuments, one at each corner of the claim.

The location monument on which this notice is posted is situated within Section 28, Township 9 South, Range 11 East, Gila Salt River Base and Meridian, Arizona. This claim encompasses portions of the following: N 1/2, SW 1/4, SE 1/4, Section 28, Township 9 South, Range 11 East.

Gila Salt River Base and Meridian, Arizona.

The locality of this claim with reference to some natural object or permanent monument and additional information (if any) concerning its locality are as follows: None

DATED AND POSTED on the ground this 3rd day of January, 2018.

LOCATOR (s) Owners

ACUITY RESOURCES LLC

By

Ron Parker/Agent for Owners

AHC449084

# T9S, R11E Section 28,

# Acuity Claims

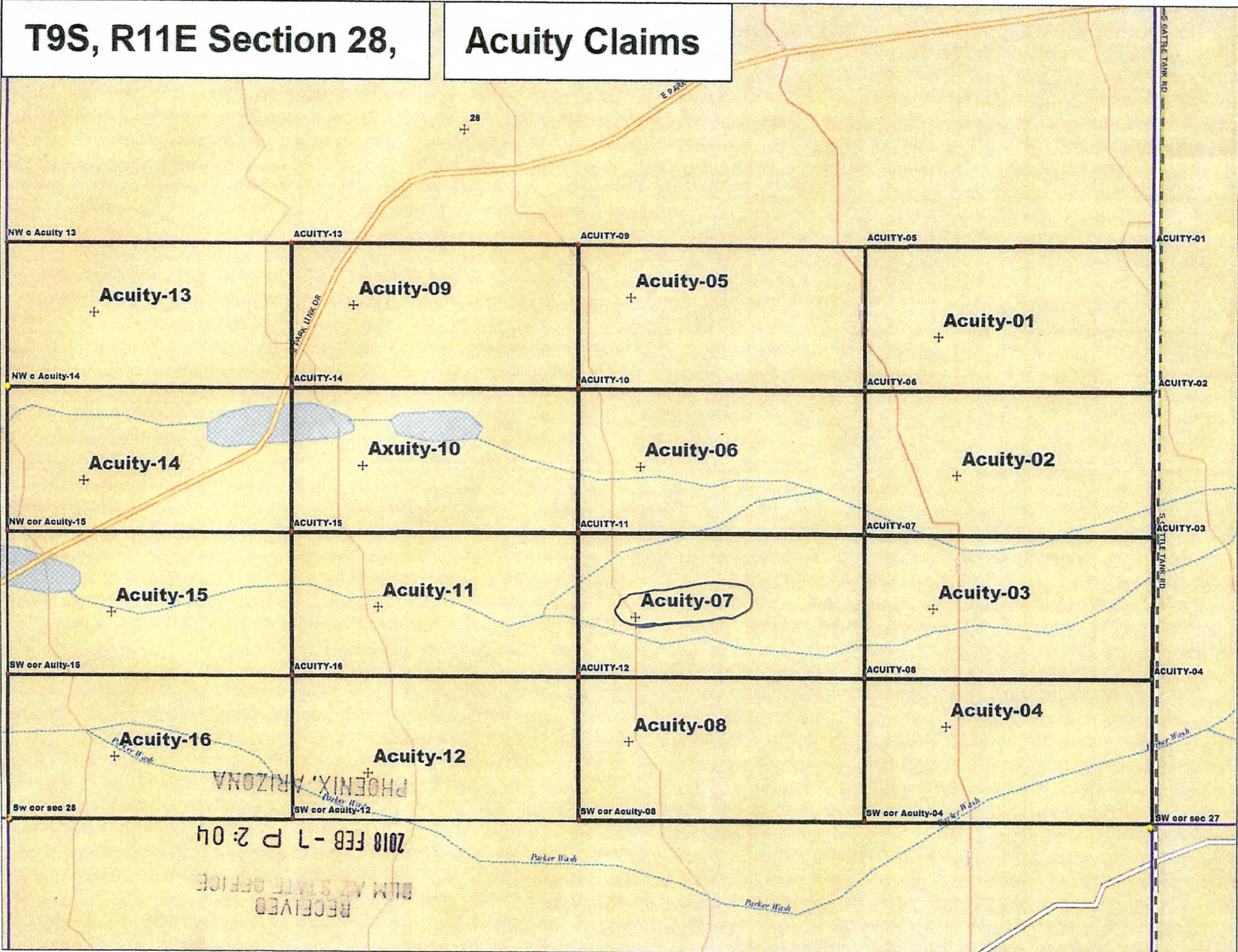

Data use subject to license.

© DeLorme. Topo North America™ 10.

www.delorme.com

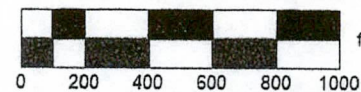

Data Zoom 15-3

**LOCATION NOTICE FOR PLACER MINING CLAIM**

NOTICE IS HEREBY GIVEN that the Acuity 08 placer mining claim has been located by ACUITY RESOURCES LLC. whose current mailing address is 2140 S. DuPont Hwy. Camden, Delaware 19934

BLM	RECEIVED
DATE	BLM AZ STAFF OFFICE
STAMP	2018 FEB - 7 P 2: 04
	PHOENIX, ARIZONA

The general course of this claim is east to West and is situated in Pinal County, Arizona.

The claim is 1,320 feet in length and 660 feet in width. This claim runs from the location monument on which the location notice is posted (being the northeast corner of the said claim), approximately 660 feet in a southerly direction to the south end line and 1,320 feet in a westerly direction to the west end line.

The claim is marked by four 2"x2"x4' monuments, one at each corner of the claim.

The location monument on which this notice is posted is situated within Section 28, Township 9 South, Range 11 East, Gila Salt River Base and Meridian, Arizona. This claim encompasses portions of the following: S 1/2, SW 1/4, SE 1/4, Section 28, Township 9 South, Range 11 East.

Gila Salt River Base and Meridian, Arizona.

The locality of this claim with reference to some natural object or permanent monument and additional information (if any) concerning its locality are as follows: None

DATED AND POSTED on the ground this 3rd day of January, 2018.

LOCATOR (s) Owners

ACUITY RESOURCES LLC

By



Ron Parker/Agent for Owners

AMC449085

# T9S, R11E Section 28,

# Acuity Claims

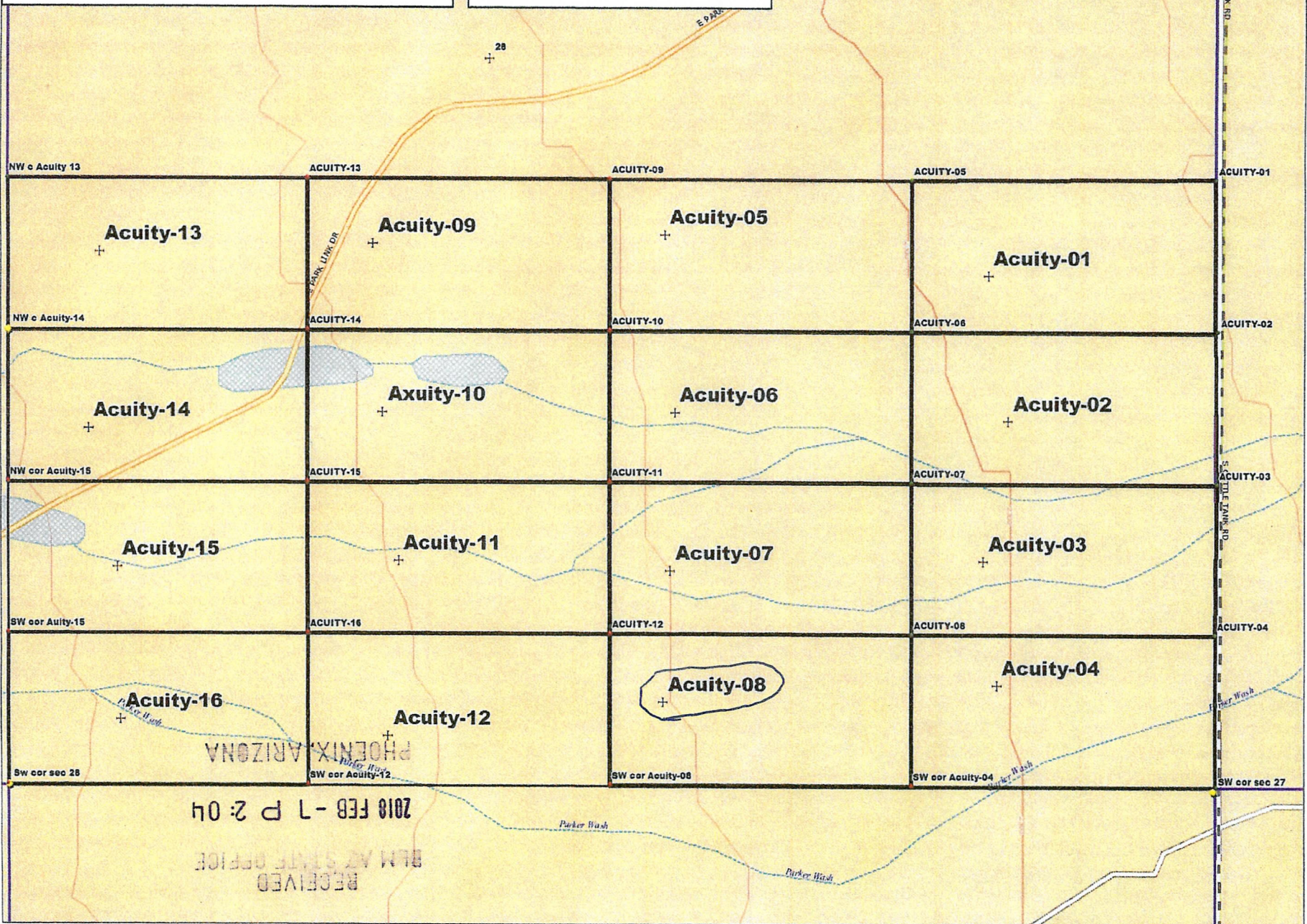

Data use subject to license.

© DeLorme. Topo North America™ 10.

www.delorme.com

AMC449085



MN (9.9° E)

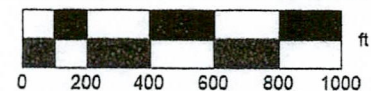

Data Zoom 15-3

**LOCATION NOTICE FOR PLACER MINING CLAIM**

NOTICE IS HEREBY GIVEN that the Acuity 09 placer mining claim has been located by ACUITY RESOURCES LLC. whose current mailing address is 2140 S. DuPont Hwy. Camden, Delaware 19934



The general course of the claim is East to West and is situated in Pinal County, Arizona.

The claim is 1,320 feet in length and 660 feet in width. This claim runs from the location monument on which the location notice is posted (being the northeast corner of the said claim), approximately 660 feet in a southerly direction to the south end line and 1,320 feet in a westerly direction to the west end line.

The claim is marked by four 2"x2"x4' monuments, one at each corner of the claim.

The location monument on which this notice is posted is situated within Section 28, Township 9 South, Range 11 East, Gila Salt River Base and Meridian, Arizona. This claim encompasses portions of the following: N 1/2, NE 1/4, SW 1/4, Section 28, Township 9 South, Range 11 East.

Gila Salt River Base and Meridian, Arizona.

The locality of this claim with reference to some natural object or permanent monument and additional information (if any) concerning its locality are as follows: None

DATED AND POSTED on the ground this 3rd day of January, 2018.

LOCATOR (s) Owners

ACUITY RESOURCES LLC.

By

Ron Parker/Agent for Owners

AMC449086

# T9S, R11E Section 28,

# Acuity Claims

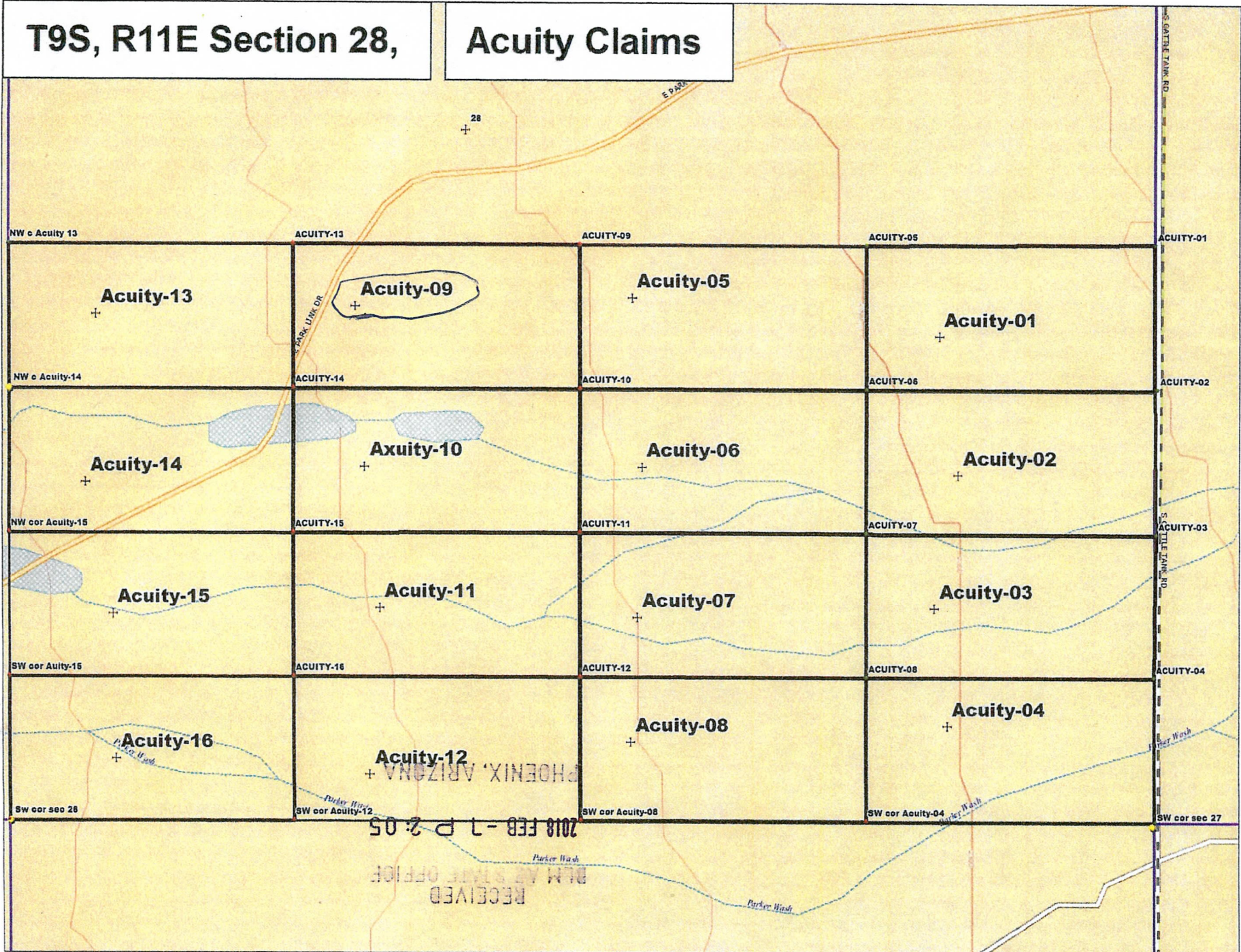

Data use subject to license.

© DeLorme. Topo North America™ 10.

www.delorme.com

AMC449086

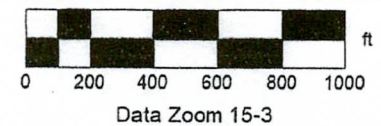



**LOCATION NOTICE FOR PLACER MINING CLAIM**

NOTICE IS HEREBY GIVEN that the Acuity 10 placer mining claim has been located by ACUITY RESOURCES LLC. whose current mailing address is 2140 S. DuPont Hwy. Camden, Delaware 19934

RECEIVED  
BLM AP STATE OFFICE  
2010 FEB -7 P 2:05  
PHOENIX, ARIZONA  
BLM  
DATE  
STAMP

The general course of this claim is East to West and is situated in Pinal County, Arizona.

The claim is 1,320 feet in length and 660 feet in width. This claim runs from the location monument on which the location notice is posted (being the northeast corner of the said claim), approximately 660 feet in a southerly direction to the south end line and 1,320 feet in a westerly direction to the west end line.

The claim is marked by four 2"x2"x4' monuments, one at each corner of the claim.

The location monument on which this notice is posted is situated within Section 28, Township 9 South, Range 11 East, Gila Salt River Base and Meridian, Arizona. This claim encompasses portions of the following: S 1/2, NE 1/4, SW 1/4, Section 28, Township 9 South, Range 11 East.

Gila Salt River Base and Meridian, Arizona.

The locality of this claim with reference to some natural object or permanent monument and additional information (if any) concerning its locality are as follows: None

DATED AND POSTED on the ground this 3rd day of January, 2018.

LOCATOR (s) Owners

ACUITY RESOURCES LLC.



By

Ron Parker/Agent for Owners

AMC449087

# T9S, R11E Section 28,

# Acuity Claims

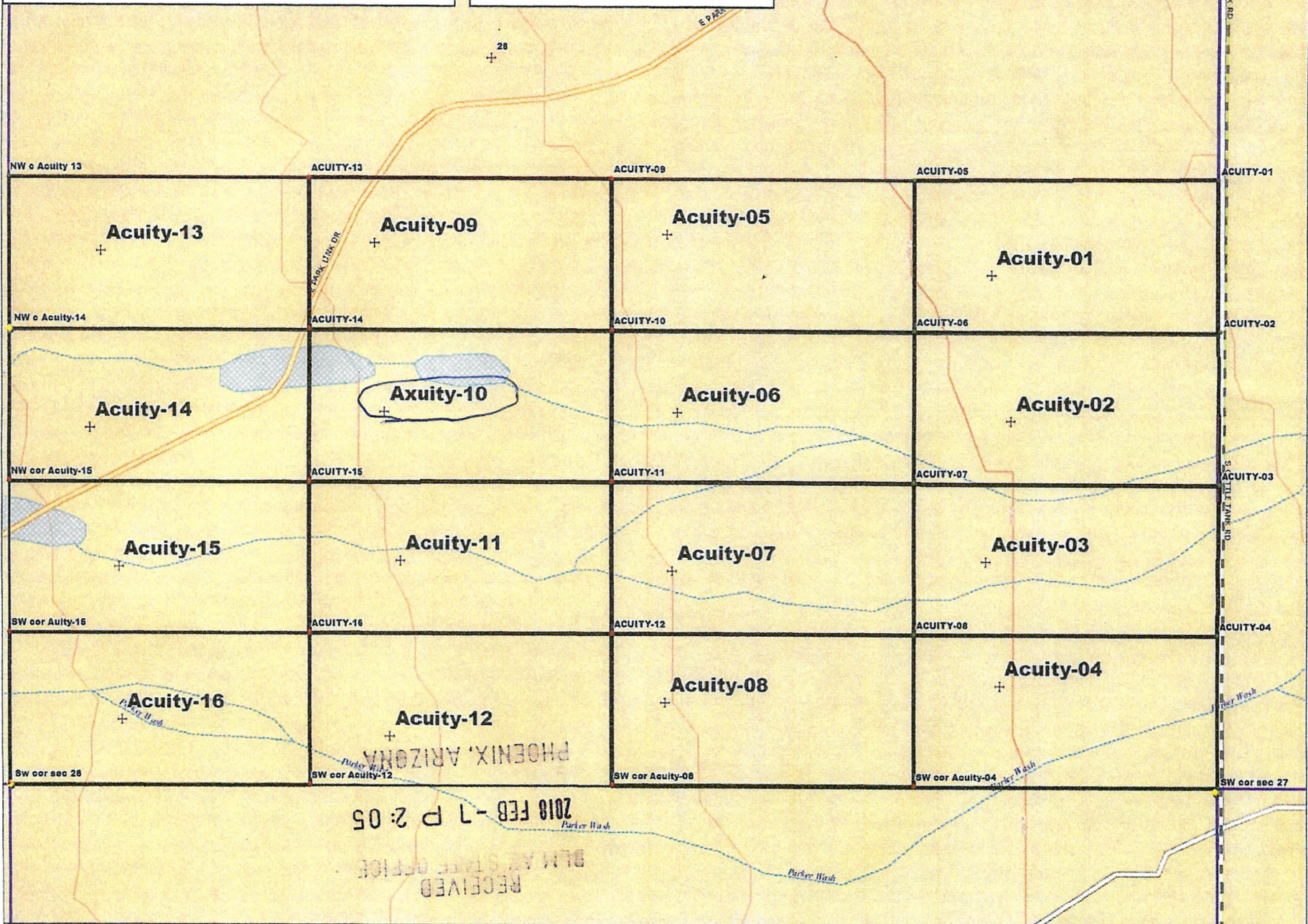

Data use subject to license.

© DeLorme. Topo North America™ 10.

www.delorme.com



MN (9.9° E)

AMC49087



Data Zoom 15-3

**LOCATION NOTICE FOR PLACER MINING CLAIM**

NOTICE IS HEREBY GIVEN that the Acuity 11 placer mining claim has been located by ACUITY RESOURCES LLC. whose current mailing address is 2140 S. DuPont Hwy. Camden, Delaware 19934.

BLM		
DATE	PHOENIX, ARIZONA	RECEIVED
STAMP		BLM AZ STATE OFFICE

2018 FEB -7 P 2:05

The general course of this claim is East to West and is situated in Pinal County, Arizona.

The claim is 1,320 feet in length and 660 feet in width. This claim runs from the location monument on which the location notice is posted (being the northeast corner of the said claim), approximately 660 feet in a southerly direction to the south end line and 1,320 feet in a westerly direction to the west end line.

The claim is marked by four 2"x2"x4' monuments, one at each corner of the claim.

The location monument on which this notice is posted is situated within Section 28, Township 9 South, Range 11 East, Gila Salt River Base and Meridian, Arizona. This claim encompasses portions of the following: N 1/2, SE 1/4, SW 1/4, Section 28, Township 9 South, Range 11 East.

Gila Salt River Base and Meridian, Arizona.

The locality of this claim with reference to some natural object or permanent monument and additional information (if any) concerning its locality are as follows: None

DATED AND POSTED on the ground this 3rd day of January, 2018.

LOCATOR (s) Owners

ACUITY RESOURCES LLC.

By 

Ron Parker/Agent for Owners

AMC449088

# T9S, R11E Section 28,

# Acuity Claims

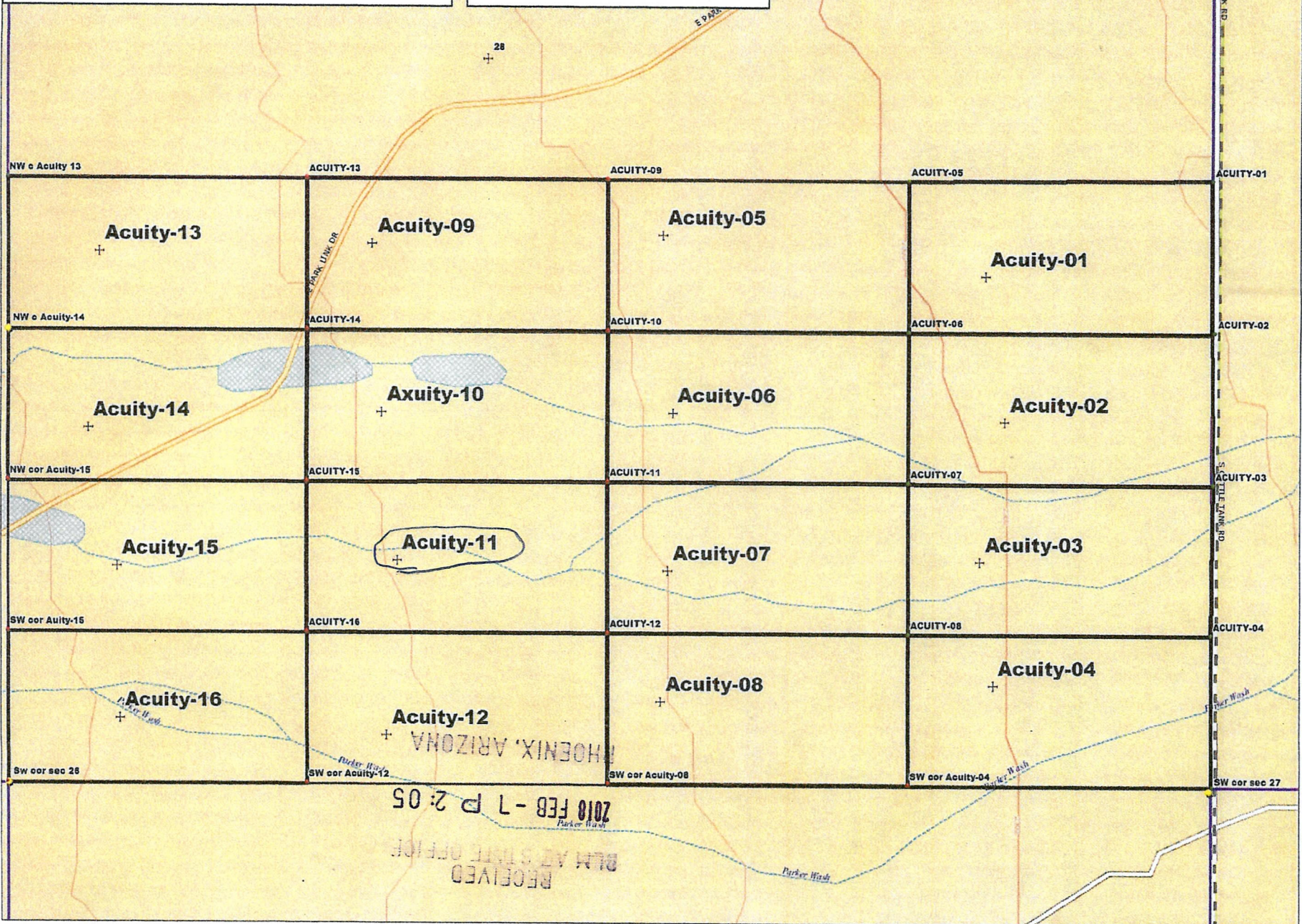

Data use subject to license.

© DeLorme. Topo North America™ 10.

www.delorme.com



AMC449088

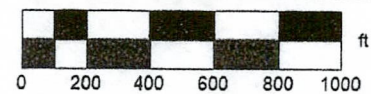

Data Zoom 15-3

**LOCATION NOTICE FOR PLACER MINING CLAIM**

NOTICE IS HEREBY GIVEN that the Acuity 12 placer mining claim has been located by ACUIITY RESOURCES LLC. whose current mailing address is 2140 S. DuPont Hwy. Camden, Delaware 19934.

RECEIVED  
BLM AZ STAFF OFFICE  
2018 FEB -7 P 2:06  
PHOENIX, ARIZONA  
BLM  
DATE  
STAMP

The general course of this claim is East to West and is situated in Pinal County, Arizona.

The claim is 1,320 feet in length and 660 feet in width. This claim runs from the location monument on which the location notice is posted (being the northeast corner of the said claim), approximately 660 feet in a southerly direction to the south end line and 1,320 feet in a westerly direction to the west end line.

The claim is marked by four 2"x2"x4' monuments, one at each corner of the claim.

The location monument on which this notice is posted is situated within Section 28, Township 9 South, Range 11 East, Gila Salt River Base and Meridian, Arizona. This claim encompasses portions of the following: S 1/2, SE 1/4, SW 1/4, Section 28, Township 9 South, Range 11 East.

Gila Salt River Base and Meridian, Arizona.

The locality of this claim with reference to some natural object or permanent monument and additional information (if any) concerning its locality are as follows: None

DATED AND POSTED on the ground this 3rd day of January, 2018.

LOCATOR (s) Owners

ACUIITY RESOURCES LLC

By 

Ron Parker/Agent for Owners

AMC449089

# T9S, R11E Section 28,

# Acuity Claims

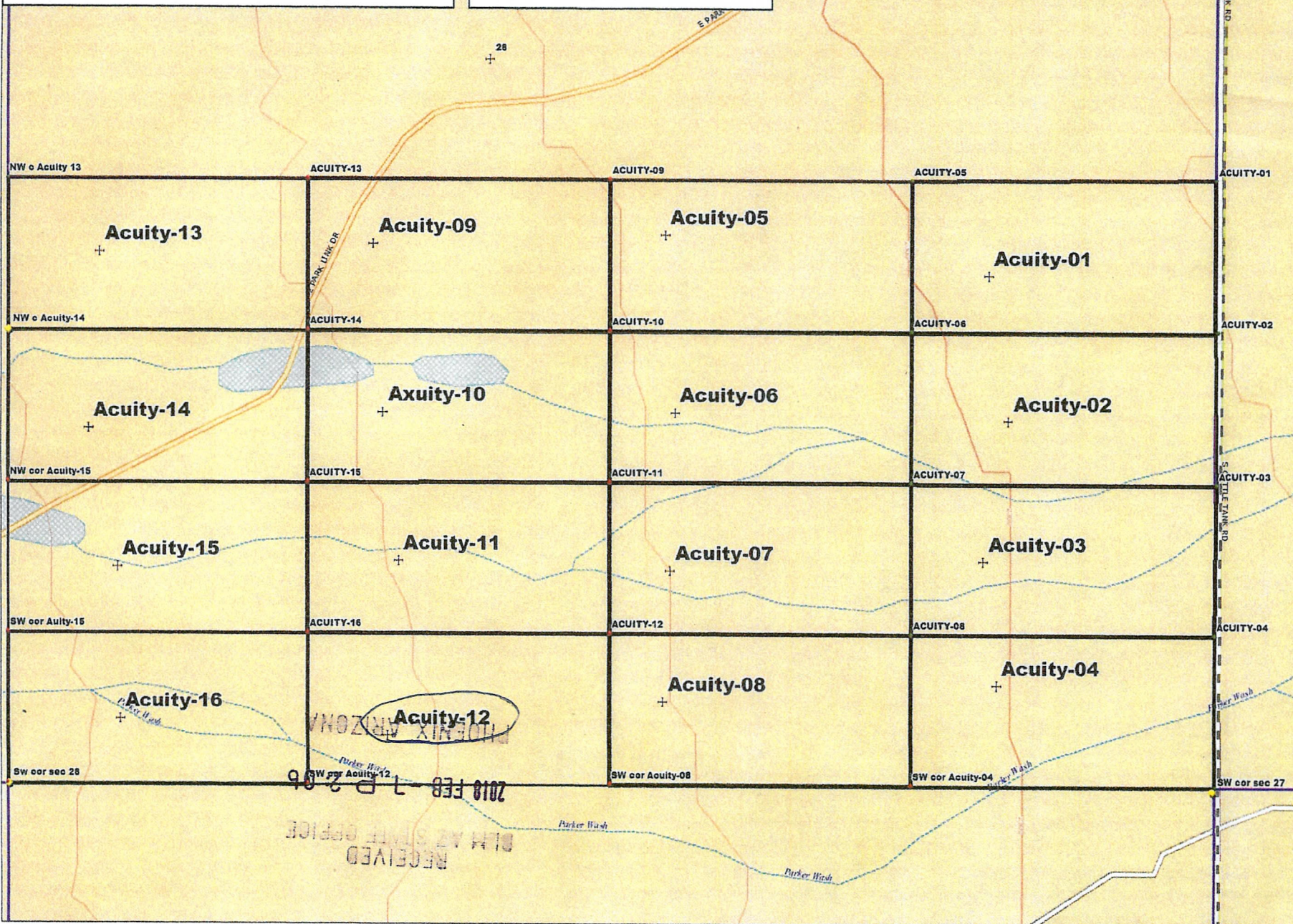

Data use subject to license.

© DeLorme. Topo North America™ 10.

www.delorme.com



AMC449089

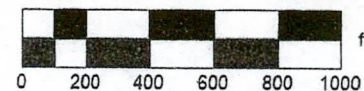

Data Zoom 15-3

**LOCATION NOTICE FOR PLACER MINING CLAIM**

NOTICE IS HEREBY GIVEN that the Acuity 13 placer mining claim has been located by ACUITY RESOURCES LLC. whose current mailing address is 2140 S. DuPont Hwy. Camden, Delaware 19934.

RECEIVED  
BLM AZ STATE OFFICE  
2010 FEB -7 P 2:06  
PHOENIX, ARIZONA  
BLM  
DATE  
STAMP

The general course of this claim is East to West and is situated in Pinal County, Arizona.

The claim is 1,320 feet in length and 660 feet in width. This claim runs from the location monument on which the location notice is posted (being the northeast corner of the said claim), approximately 660 feet in a southerly direction to the south end line and 1,320 feet in a westerly direction to the west end line.

The claim is marked by four 2"x2"x4' monuments, one at each corner of the claim.

The location monument on which this notice is posted is situated within Section 28, Township 9 South, Range 11 East, Gila Salt River Base and Meridian, Arizona. This claim encompasses portions of the following: N 1/2, NW 1/4, SW 1/4, Section 28, Township 9 South, Range 11 East. Gila Salt River Base and Meridian, Arizona.

The locality of this claim with reference to some natural object or permanent monument and additional information (if any) concerning its locality are as follows: None

DATED AND POSTED on the ground this 3rd day of January, 2018.

LOCATOR (s) Owners

ACUITY RESOURCES LLC.

By 

Ron Parker/Agent for Owners

AMC449090

# T9S, R11E Section 28,

# Acuity Claims

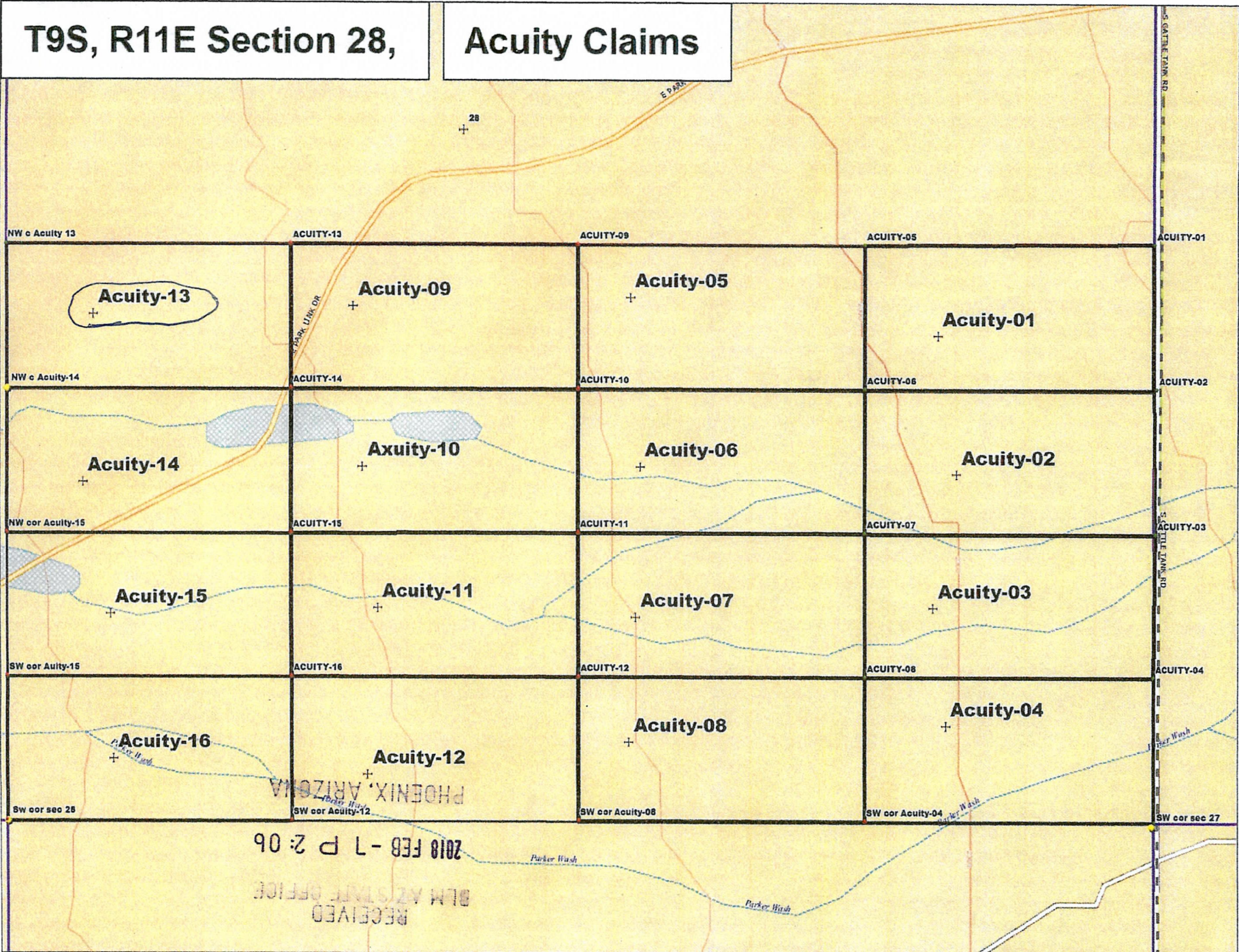

Data use subject to license.

© DeLorme. Topo North America™ 10.

www.delorme.com



AMC449090

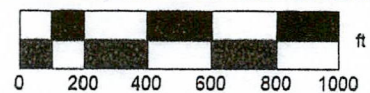

Data Zoom 15-3



**LOCATION NOTICE FOR PLACER MINING CLAIM**

NOTICE IS HEREBY GIVEN that the Acuity 14 placer mining claim has been located by ACUITY RESOURCES LLC whose current mailing address is 2140 S. DuPont Hwy. Camden, Delaware 19934

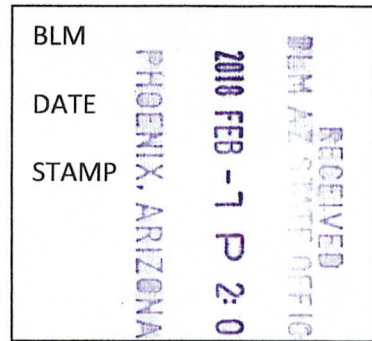

The general course of this claim is East to West and is situated in Pinal County, Arizona.

The claim is 1,320 feet in length and 660 feet in width. This claim runs from the location monument on which the location notice is posted (being the northeast corner of the said claim), approximately 660 feet in a southerly direction to the south end line and 1,320 feet in a westerly direction to the west end line.

The claim is marked by four 2"x2"x4' monuments, one at each corner of the claim.

The location monument on which this notice is posted is situated within Section 28, Township 9 South, Range 11 East, Gila Salt River Base and Meridian, Arizona. This claim encompasses portions of the following: S 1/2, NW 1/4, SW 1/4, Section 28, Township 9 South, Range 11 East. Gila Salt River Base and Meridian, Arizona.

The locality of this claim with reference to some natural object or permanent monument and additional information (if any) concerning its locality are as follows: None

DATED AND POSTED on the ground this 3rd day of January, 2018.

LOCATOR (s) Owners

ACUITY RESOURCES LLC

By 

Ron Parker/Agent for Owners

AMC449091

# T9S, R11E Section 28,

# Acuity Claims

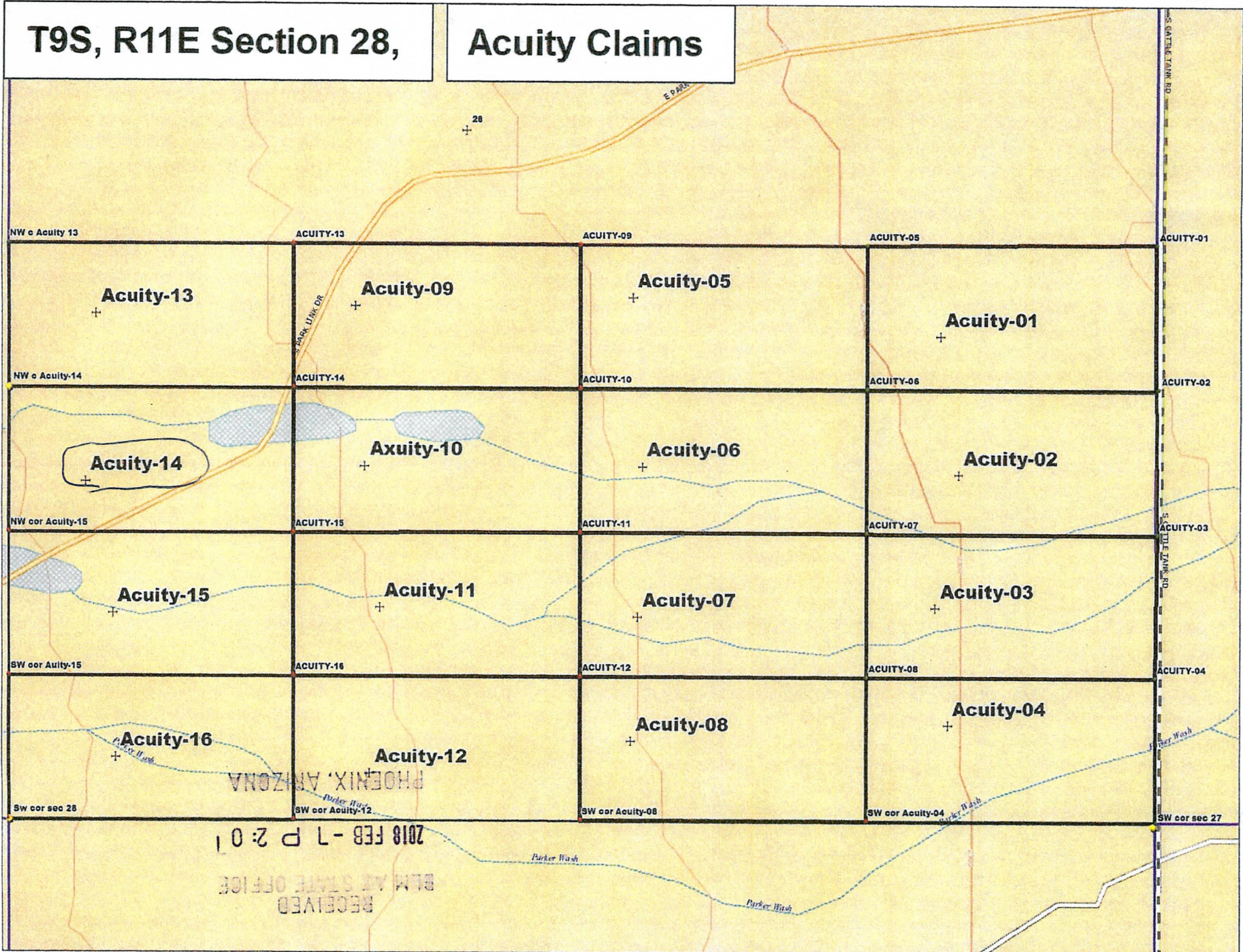

Data use subject to license.

© DeLorme. Topo North America™ 10.

www.delorme.com



MN (9.9° E)

AMC449091

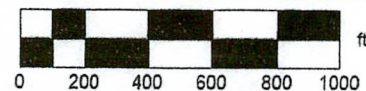

Data Zoom 15-3

**LOCATION NOTICE FOR PLACER MINING CLAIM**

NOTICE IS HEREBY GIVEN that the Acuity 15 placer mining claim has been located by ACUITY RESOURCES LLC. whose current mailing address is 2140 S. DuPont Hwy. Camden, Delaware 19934

BLM  
DATE  
STAMP

RECEIVED  
BLM AZ STATE OFFICE  
2018 FEB -7 P 2:00  
PHOENIX, ARIZONA

The general course of this claim is East to West and is situated in Pinal County, Arizona.

The claim is 1,320 feet in length and 660 feet in width. This claim runs from the location monument on which the location notice is posted (being the northeast corner of the said claim), approximately 660 feet in a southerly direction to the south end line and 1,320 feet in a westerly direction to the west end line.

The claim is marked by four 2"x2"x4' monuments, one at each corner of the claim.

The location monument on which this notice is posted is situated within Section 28, Township 9 South, Range 11 East, Gila Salt River Base and Meridian, Arizona. This claim encompasses portions of the following: N 1/2, SW 1/4, SW 1/4, Section 28, Township 9 South, Range 11 East. Gila Salt River Base and Meridian, Arizona.

The locality of this claim with reference to some natural object or permanent monument and additional information (if any) concerning its locality are as follows: None

DATED AND POSTED on the ground this 3rd day of January, 2018.

LOCATOR (s) Owners

ACUITY RESOURCES LLC.

By 

Ron Parker/Agent for Owners

AMC 449092

# T9S, R11E Section 28,

# Acuity Claims

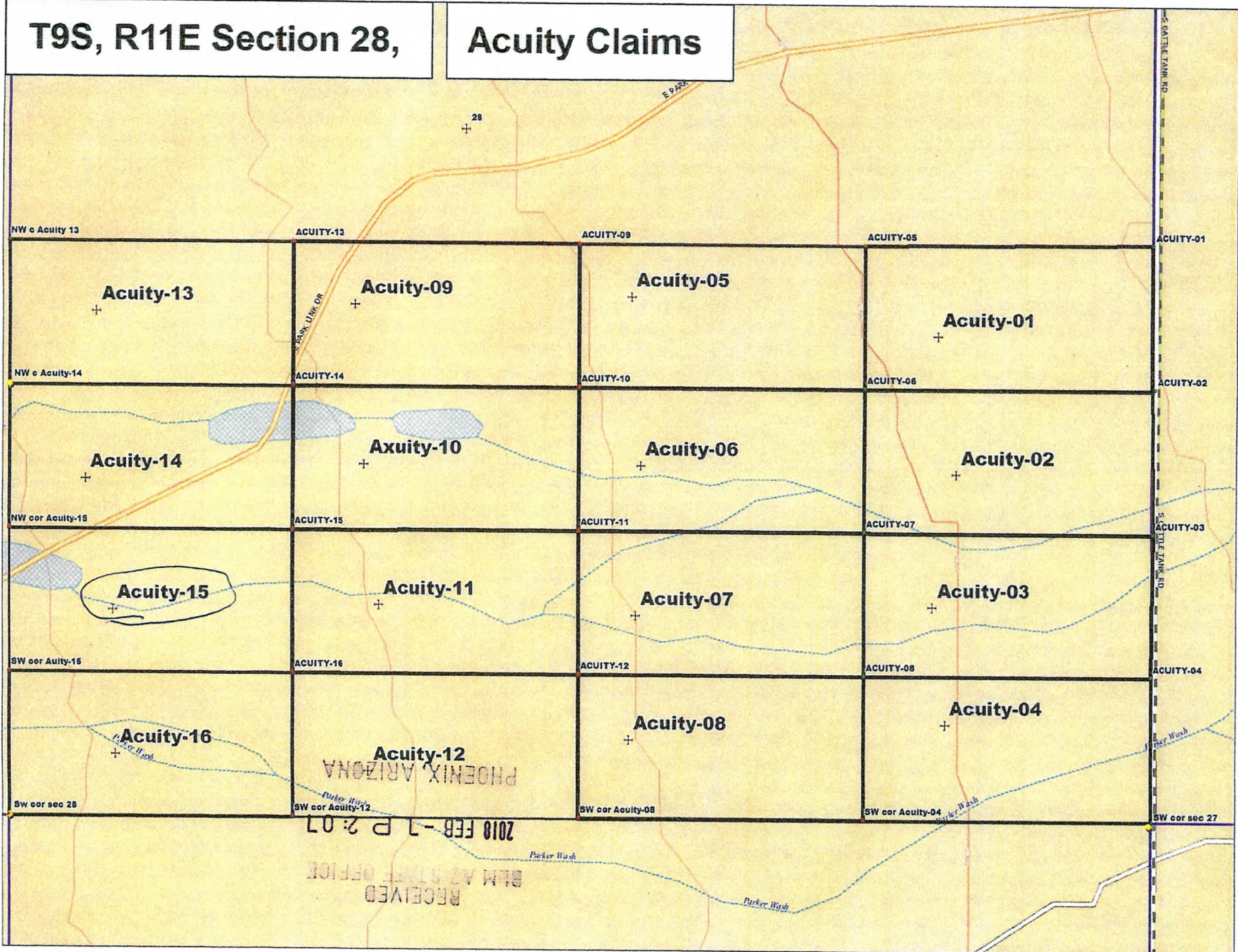

Data use subject to license.

© DeLorme. Topo North America™ 10.

www.delorme.com

2606492



MN (9.9° E)

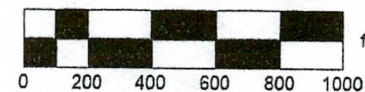

Data Zoom 15-3

**LOCATION NOTICE FOR PLACER MINING CLAIM**

NOTICE IS HEREBY GIVEN that the Acuity 16 placer mining claim has been located by ACUITY RESOURCES LLC. whose current mailing address is 2140 S. DuPont Hwy. Camden, Delaware 19934

BLM			
DATE	PHOENIX, ARIZONA	2018 FEB - 7 P 2:07	RECEIVED
STAMP			BLM AZ STATE OFFICE

The general course of this claim is east to West and is situated in Pinal County, Arizona

The claim is 1,320 feet in length and 660 feet in width. This claim runs from the location monument on which the location notice is posted (being the northeast corner of the said claim), approximately 660 feet in a southerly direction to the south end line and 1,320 feet in a westerly direction to the west end line.

The claim is marked by four 2"x2"x4' monuments, one at each corner of the claim.

The location monument on which this notice is posted is situated within Section 28, Township 9 South, Range 11 East, Gila Salt River Base and Meridian, Arizona. This claim encompasses portions of the following: S 1/2, SW 1/4, SW 1/4, Section 28, Township 9 South, Range 11 East.

Gila Salt River Base and Meridian, Arizona.

The locality of this claim with reference to some natural object or permanent monument and additional information (if any) concerning its locality are as follows: None

DATED AND POSTED on the ground this 3rd day of January, 2018.

LOCATOR (s) Owners

ACUITY RESOURCES LLC.

By 

Ron Parker/Agent for Owners

AN0449093

# T9S, R11E Section 28,

# Acuity Claims

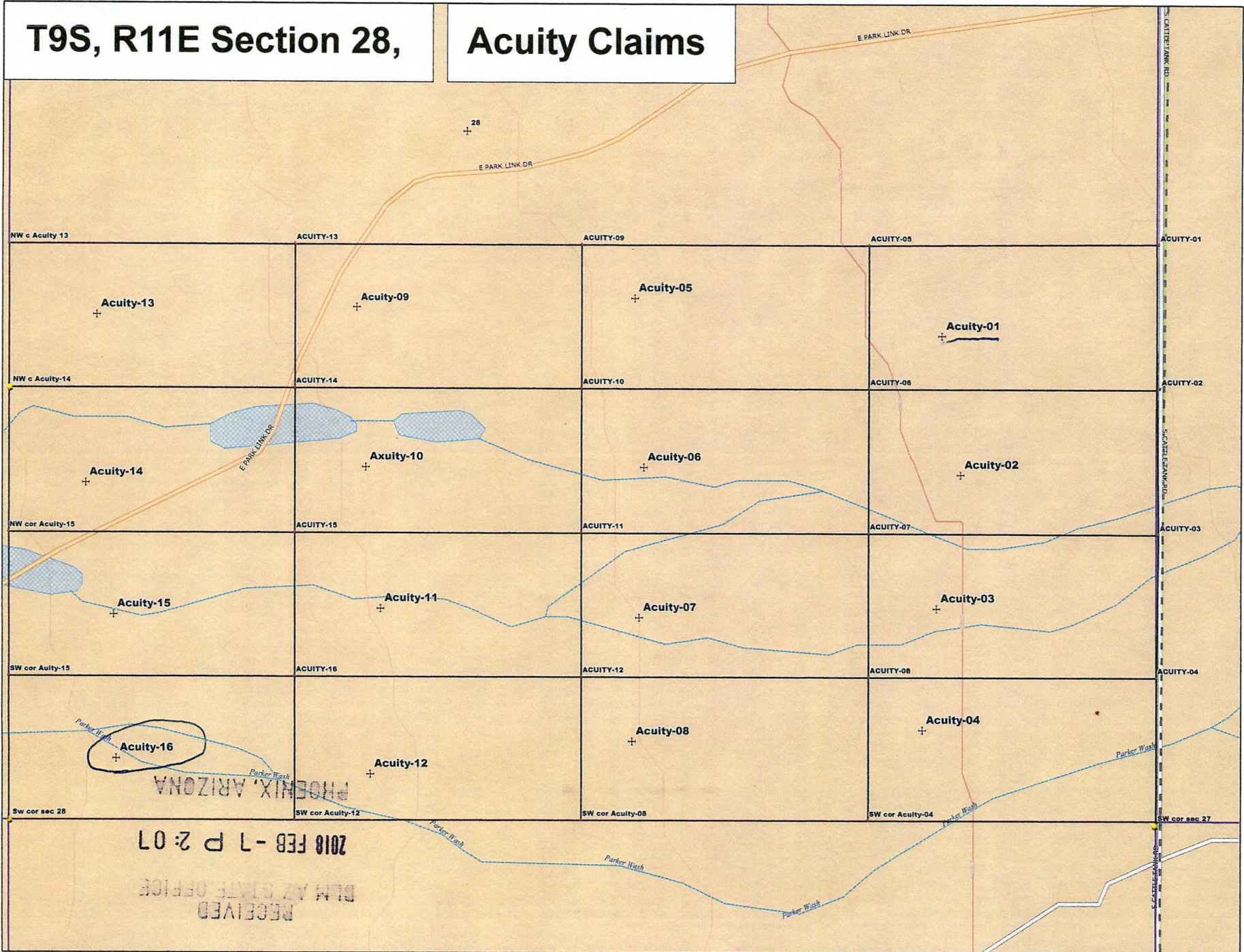

RECEIVED  
 DEN AZ STATE OFFICE  
 2018 FEB - 1 P 2:07  
 PHOENIX, ARIZONA

AMC449093

Data use subject to license.

© DeLorme. Topo North America™ 10.

www.delorme.com

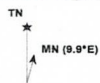

Scale 1 : 7,200

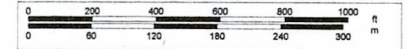

1" = 600.0 ft

Data Zoom 15-5

Input Parameters for Geographic Report with Land

System Id = CR

Admin State = AZ

Geo State =

Casetype Begins With

Case Disp Txt = AUTHORIZED, CANCELLED, EXPIRED, PENDING, REJECTED, VOID, WITHDRAWN

Mer Twp Rng =

Section =

Mtrs = 14 0090S 0110E 028, 14 0090S 0110E 999

Commodity =

Commodity Txt =

Pending Org =

Pend Org Decode =

Total Rows Returned: 1

RUN TIME: 07:32 AM

UNITED STATES DEPARTMENT OF INTERIOR  
BUREAU OF LAND MANAGEMENT  
GEOGRAPHIC REPORT WITH LAND  
Sorted by Serial Number

RUN DATE: 02/14/2018  
Page 1 of 1

Adm State: AZ

Serial Number: AZA 021398  
Total Case Acres: 75.760

<u>Casetype</u>	<u>Case Disp</u>				<u>Sect</u>	<u>Sur Typ</u>	<u>Sur Num</u>	<u>Suff</u>	<u>Subdivision</u>	<u>Act Pend</u>
282201	AUTHORIZED	14	0090S	0110E	028	ALIQ			S2N2,NW;	

Serial Number: AZA 022906  
Total Case Acres: 62.860

<u>Casetype</u>	<u>Case Disp</u>				<u>Sect</u>	<u>Sur Typ</u>	<u>Sur Num</u>	<u>Suff</u>	<u>Subdivision</u>	<u>Act Pend</u>
281001	AUTHORIZED	14	0090S	0110E	028	MNR		1	E2NE,E2SE;	Y





RECEIVED  
BLM AZ STATE OFFICE

2018 FEB -7 P 2:01

PHOENIX, ARIZONA

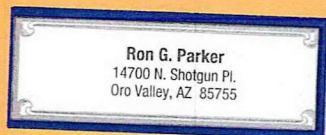

BLM  
One North Central Avenue  
Suite 800  
Phoenix, AZ 85004-4427

